

PARKING PROVIDED:
 REGULAR: 37
 H/C: 2
 39

BENCHMARK:
 HARRIS COUNTY FLOODPLAIN REFERENCE MARK NUMBER 110055 DESCRIBED AS A BRASS DISK STAMPED 110055 AT CYPRESS STATION, 0.95 MILES NORTH OF THE INTERSECTION OF CYPRESS STATION AND FM 1960 IN THE CYPRESS WATERSHED.
 PUBLISHED ELEV = 96.78'
 NAVD 1988 (2001 ADJ.)

TBM:
 TBM: (SITE BENCHMARK) RAILROAD SPIKE IN POWER POLE LOCATED APPROXIMATELY 29 FEET NORTH OF THE SOUTHEAST CORNER OF THE SUBJECT PROPERTY.
 ELEVATION 112.05 FEET NAVD 1988 (2001 ADJ.)

INTERSTATE HIGHWAY 45
 (WIDTH VARIES)

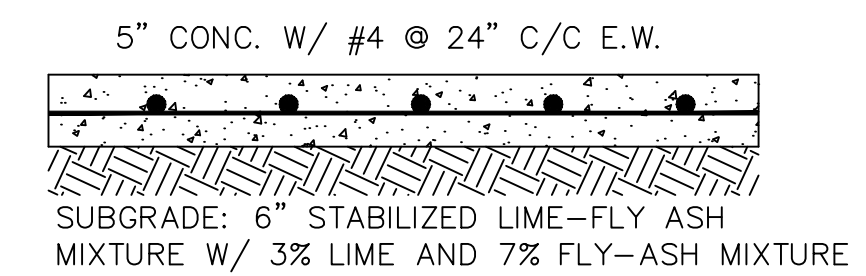

PARKING LOTS
 AUTOMOBILES ONLY

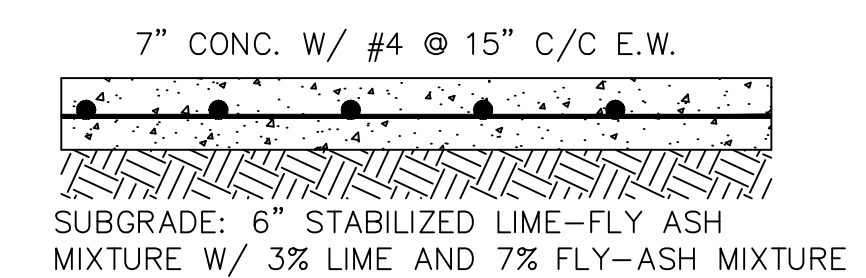

DUMPSTER PAD



STEWART CONSULTING SERVICES
 CIVIL ENGINEERS | PLANNERS | CONSTRUCTION MGMT.
 TBPE FIRM F-17175
 P.O. BOX 82
 HUMBLE, TX 77347
 PH: (713) 446-8537
 FAX: (281) 858-2335
 www.stewartconsultingservices.com

17211 PAD SITE
 17211 IH45
 HOUSTON, HARRIS CO., TX 77090

PROJECT:

REV	ISSUE DATE	DESCRIPTION
0	06/04/2018	ISSUED FOR PERMIT/BID

SHEET TITLE:
SITE PLAN

PRJ NAME: 17211 PAD SITE
 DATE: JUNE 03, 2018

SHEET NO:
C1.0