

NOTES:

1. INSTALL SERVICE RACK AND PANEL 'H' (HOUSE), THEN CONNECT EMERGENCY EGRESS LIGHTS AND WALL PACKS AS INDICATED.

OVERLAND TRAILS DRIVE  
(R.O.W. VARIES - C.C.F. NO. F668080 R.P.R.H.C.)

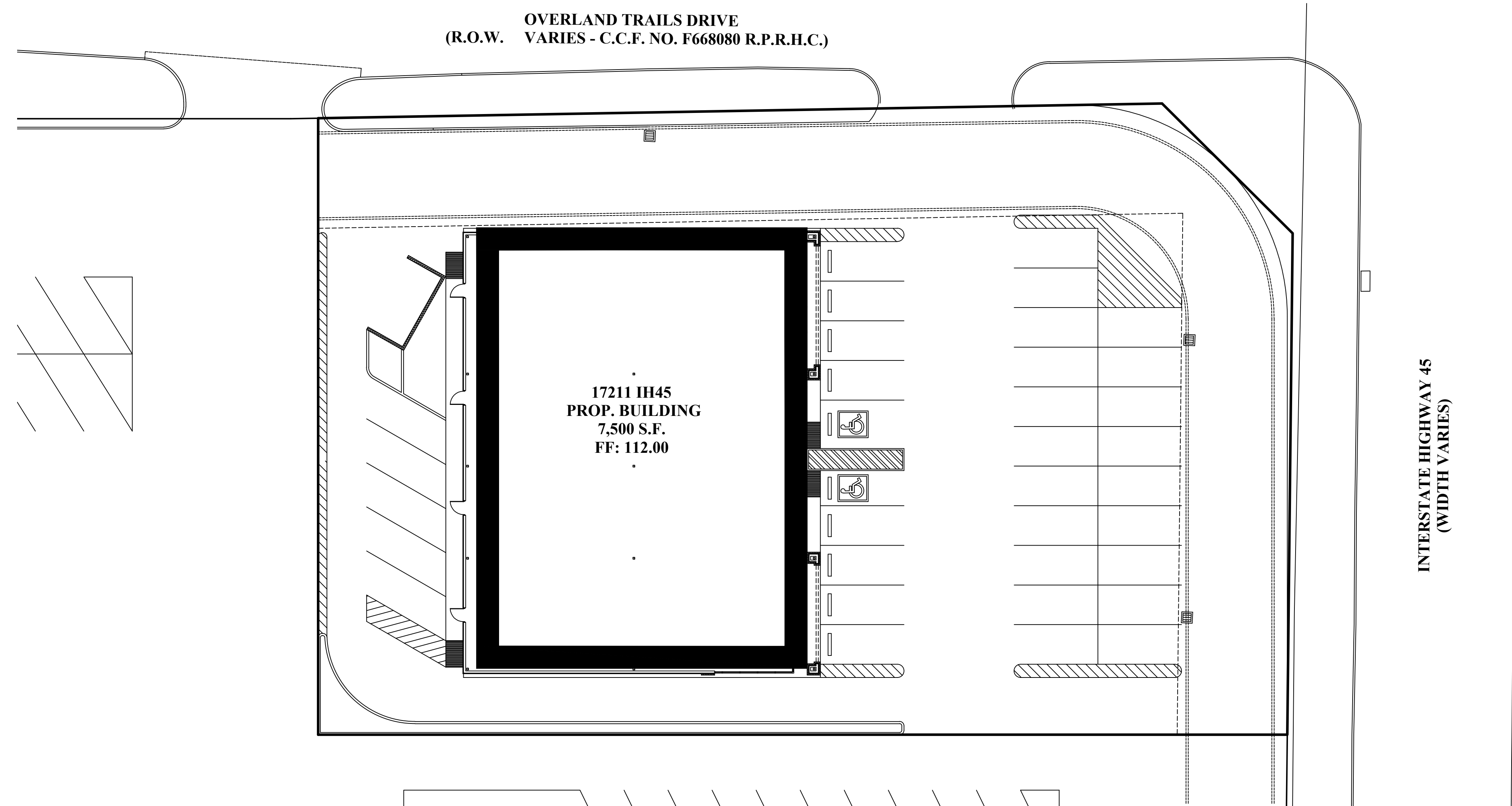

17211 IH45  
PROP. BUILDING  
7,500 S.F.  
FF: 112.00

INTERSTATE HIGHWAY 45  
(WIDTH VARIES)

ELECTRICAL POWER PLAN

1/16"=1'-0"

**LEGEND**

- ELECTRICAL OUTLET
- TELEPHONE OUTLET
- PHONE / DATA OUTLET

MARK	DESCRIPTION
	FLUORESCENT FIXTURE
	FLUORESCENT FIXTURE WITH BATTERY PACK
	WALL BRACKET FIXTURE
	FLUORESCENT FIXTURE
	EXIT LIGHT
	SINGLE RECEPTACLE
	DUPLEX CONVENIENCE OUTLET
	FLOOR MOUNTED DUPLEX OUTLET
	240V OUTLET
	OUTLET WITH GROUND FAULT CIRCUIT INTERRUPTER
	RECEPTACLE WITH ISOLATED GROUND
	QUAD PLEX CONVENIENCE OUTLET
	WALL SWITCH
	3-WAY SWITCH
	SWITCH W/PILOT LIGHT
	PASSIVE INFRARED WALL SWITCH/SENSOR W/MANUAL ON/OFF CONTROL
	MOTDR RATED SWITCH
	MOTDR
	CIRCUIT HOME-RUN TO PANEL
	SWITCH LEG
	TELEPHONE OUTLET 1" TO ABOVE CEILING WITH WIRE TO TELEPHONE TERMINAL BOARD
	DISCONNECT SWITCH
	JUNCTION BOX
	120V HARDWIRED CONNECTION
	208V/1Ø HARDWIRED CONNECTION
	MOTION DETECTOR, ARROW INDICATES DIRECTION
	PHOTOCELL
	208V/3Ø HARDWIRED CONNECTION
	ELECTRICAL PANEL

**JAMES E. THOMPSON & ASSOCIATES ENGINEERS**

First National Bank of Alvin Building  
1600 East Highway 6, Suite 331  
Alvin, Texas 77511  
T: (832)526-0160

- Mechanical • Electrical •
- Plumbing Design •
- Firm Registration #F1288

Revision	Date	Issue
Client		
Architect		
Engineer		
General Contractor		
Sub-contractor		

PREPARED FOR:

NEW PROJECT  
SHELL BUILDING 1  
OVERLAND TRAILS DRIVE  
17211 IH 45  
HOUSTON, TX 77090

Project Name:	Name	Date
Drawn By:	SR	12/26/17
Check By PIC:	JET	12/26/17
Check by PM:	JET	12/26/17
Approved By:	JET	12/26/17

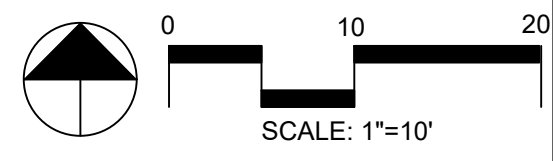

Date Created: 12/26/17  
Project Number: -

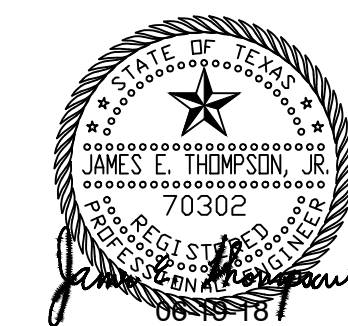

Drawing Title: ELECTRICAL POWER PLAN

Sheet Number: E2.0